



# Organization and Services

---

AIXM 5 Public Design Review  
February 7-8, 2006  
Washington DC



# Definitions and Purpose

---

- Organization Authority
  - “Model organizations and authorities”
  - ATS organizations (IATA), Aircraft Operators (United), States (Argentina), Groups of States (NATO Members)
- Unit
  - “‘Unit’ that provides services”
  - Approach Control, Military, Tower, ARTCC
- Service
  - Services furnished to pilots, flights, aircraft operators, institutions and others
  - Approach, Information, Weather

# Organizations and Services data model

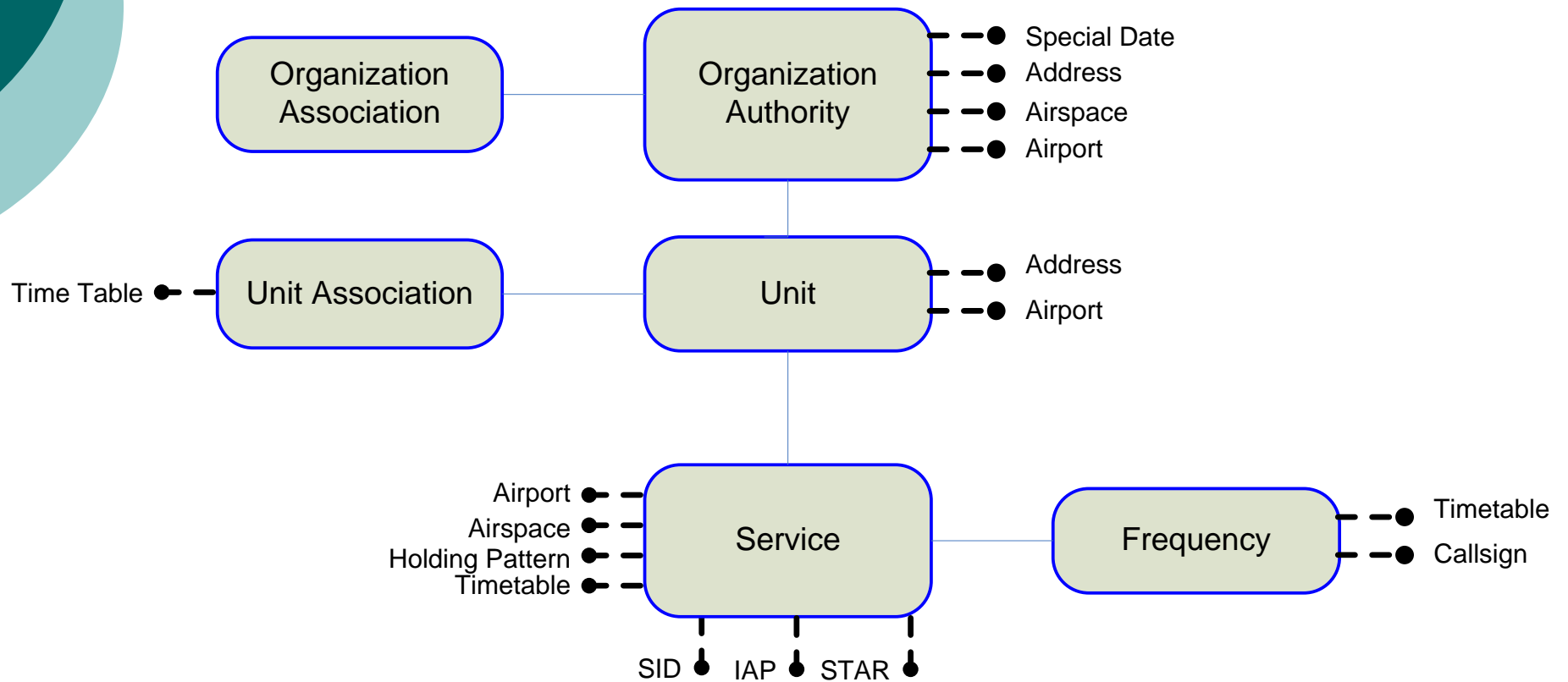



# Unit Types

---

## **OTHER**

**ACC** [Area Control Centre.]

**ADSU** [Automatic Dependent Surveillance Unit.]

**ADVC** [Advisory Centre.]

**ALPS** [Alerting Post.]

**AOF** [Aeronautical Information Services Office.]

**APP** [Approach Control office.]

**APP-ARR** [Arrivals Approach Control office.]

**APP-DEP** [Departures Approach Control office.]

**ARO** [Aerodrome Reporting Office/ATS Reporting Office.]

**ATCC** [Air Traffic Control Centre.]

**ATFMU** [Air Traffic Flow Management Unit.]

**ATMU** [Air Traffic Management Unit.]

**ATSU** [Air Traffic Services Unit.]

**BOF** [Briefing Office.]

**BS** [Commercial Broadcasting Station.]

**COM** [Communications office/centre.]

**FCST** [Forecasting office.]

**FIC** [Flight Information Centre.]

**GCA** [Ground Controlled Approach Systems office.]



# Unit Types

---

**MET** [Meteorological office.]  
**MWO** [Meteorological Watch Office.]  
**NOF** [International NOTAM Office.]  
**OAC** [Oceanic Control Centre.]  
**PAR** [Precision Approach Radar centre.]  
**RAD** [Radar unit/office.]  
**RAFC** [Regional Area Forecast Centre.]  
**RCC** [Rescue Co-ordination Centre.]  
**RSC** [Rescue Sub-Centre.]  
**SAR** [Search And Rescue centre.]  
**SMC** [Surface Movement Control office.]  
**SMR** [Surface Movement Radar office.]  
**SRA** [Surveillance Radar Approach office/centre.]  
**SSR** [Secondary Surveillance Radar centre.]  
**TAR** [Terminal Area surveillance Radar office/centre.]  
**TWR** [Aerodrome Control Tower.]  
**UAC** [Upper Area Control Centre.]  
**UDF** [UHF Direction-Finding station.]  
**UIC** [Upper Information Centre.]  
**VDF** [VHF Direction-Finding station.]



# Unit Types

---

**WAFC** [World Area Forecast Centre.]

**ARTCC** [Air Route Traffic Control Center.]

**FSS** [Flight Service Station.]

**TRACON** [Terminal Radar Approach Control.]

**MIL** [Military station/unit] (or Military office in general).]

**MILOPS** [Planning/briefing office for military flight operations.]

# Service Types

<b>OTHER</b>	<b>ATS</b> [Air Traffic Service.]	<b>RCC</b> [Rescue Co-ordination service.]
<b>ACS</b> [Area Control Service.]	<b>BOF</b> [Briefing service.]	<b>SAR</b> [Search And Rescue service.]
<b>ADS</b> [Automatic Dependent Surveillance service.]	<b>BS</b> [commercial Broadcasting Service.]	<b>SIGMET</b> [SIGMET service.]
<b>ADVS</b> [Advisory service.]	<b>COM</b> [Communications service.]	<b>SMC</b> [Surface Movement Control service.]
<b>AFIS</b> [Aerodrome Flight Information Service.]	<b>CTAF</b> [Common Traffic Advisory Frequency Service.]	<b>SMR</b> [Surface Movement Radar service.]
<b>AFS</b> [Aeronautical Fixed Service.]	<b>DVDF</b> [Doppler VDF Service.]	<b>SR A</b> [Surveillance Radar Approach service.]
<b>AIS</b> [Aeronautical Information Service.]	<b>EFAS</b> [En-route Flight Advisory Service.]	<b>SSR</b> [Secondary Surveillance Radar service.]
<b>ALRS</b> [Alerting Service.]	<b>FCST</b> [Forecasting service.]	<b>TAR</b> [Terminal Area Radar service.]
<b>AMS</b> [Aeronautical Mobile Service.]	<b>FIS</b> [Flight Information Service.]	<b>TWEB</b> [Transcribed Weather Broadcast Service.]
<b>AMSS</b> [Aeronautical Mobile Satellite Service.]	<b>FISA</b> [Automated FIS.]	<b>TWR</b> [Aerodrome Control Tower Service.]
<b>APP</b> [Approach Control Service for both Arrival AND Departure.]	<b>FSS</b> [Flight Service Station Service.]	<b>UAC</b> [Upper Area Control service.]
<b>APP-ARR</b> [Approach Control Service for Arrivals only.]	<b>GCA</b> [Ground Controlled Approach service.]	<b>UDF</b> [UHF Direction-Finding service.]
<b>APP-DEP</b> [Approach Control Service for Departures only.]	<b>OAC</b> [Oceanic Area Control service.]	<b>VDF</b> [VHF Direction-Finding service.]
<b>ARTCC</b> [Air Route Traffic Control Centre Service.]	<b>NOF</b> [International NOTAM service.]	<b>VOLMET</b> [VOLMET service.]
<b>ATC</b> [Air Traffic Control service.]	<b>MET</b> [Meteorological service.]	<b>VOT</b> [VOR Test Facility.]
<b>ATFM</b> [Air Traffic Flow Management service.]	<b>PAR</b> [Precision Approach Radar service.]	<b>OVERFLT</b> [Overflight Clearance Service.]
<b>ATIS</b> [Automated Terminal Information Service.]	<b>RAC</b> [Rules of the Air and Air Traffic Services.]	<b>ENTRY</b> [Entry Clearance Service.]
<b>ATIS-ARR</b> [Automated Terminal Information Service for Arriving Traffic.]	<b>RADAR</b> [Radar service.]	<b>EXIT</b> [Exit Clearance Service.]
<b>ATIS-DEP</b> [Automated Terminal Information Service for Departing Traffic.]	<b>RAF</b> [Regional Area Forecasting service.]	<b>INFO</b> [Information Provision Service.]
<b>ATM</b> [Air Traffic Management service.]		

# ATC Service on an Airspace Example

---

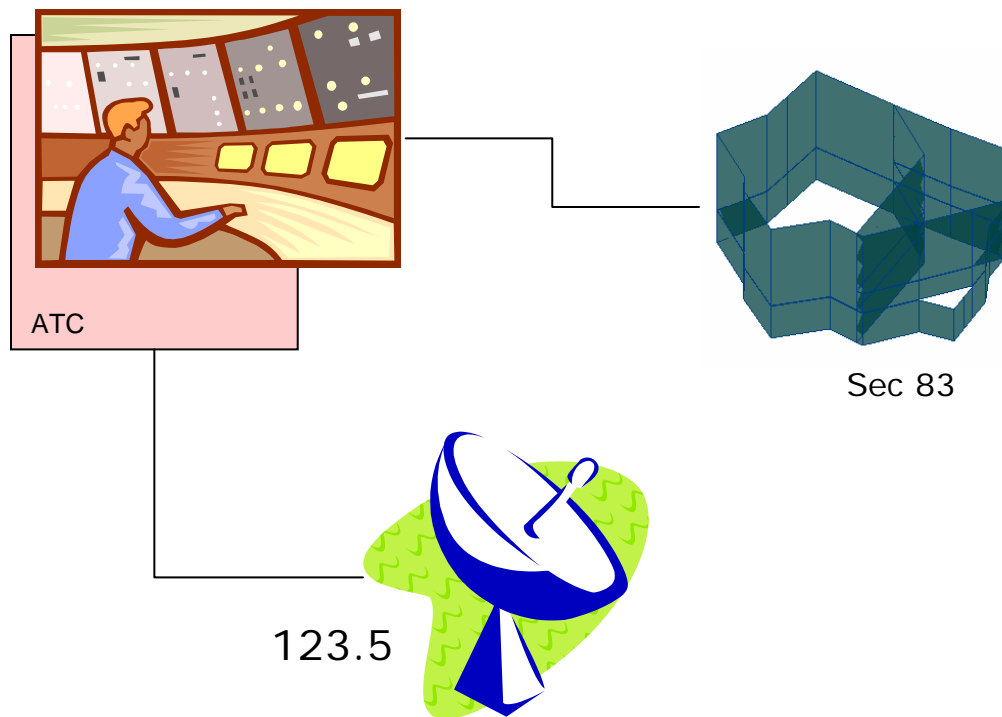



# ATC Service on an Airspace Example

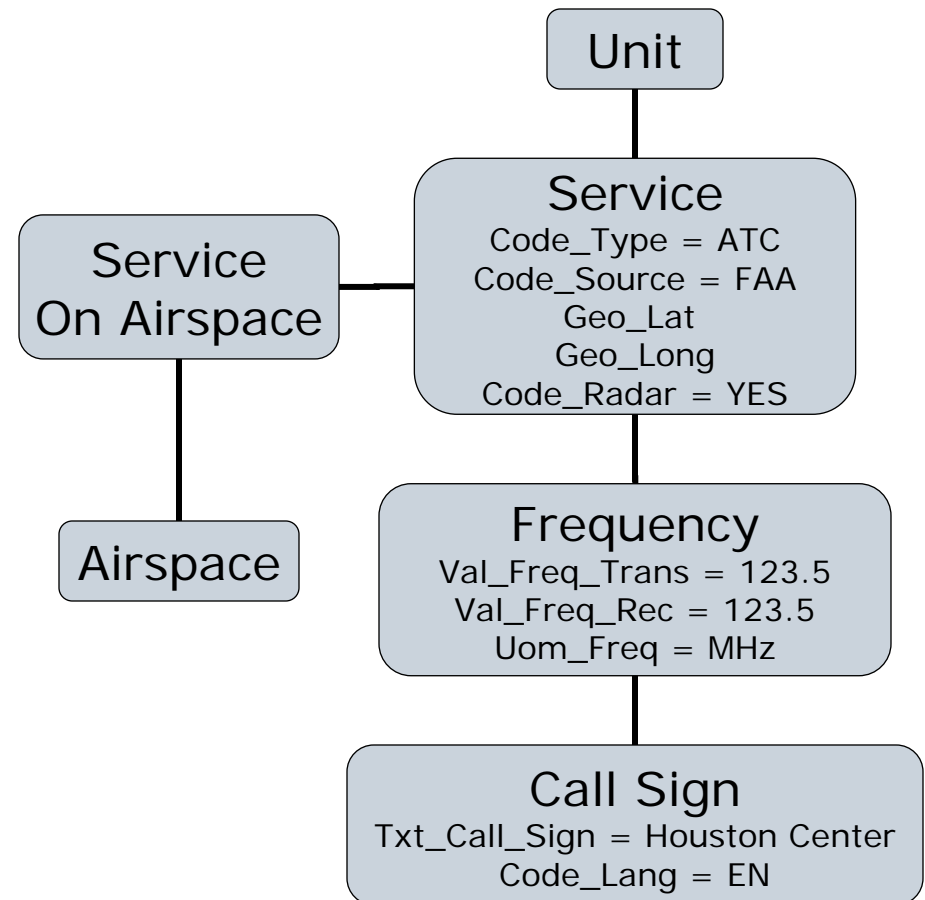
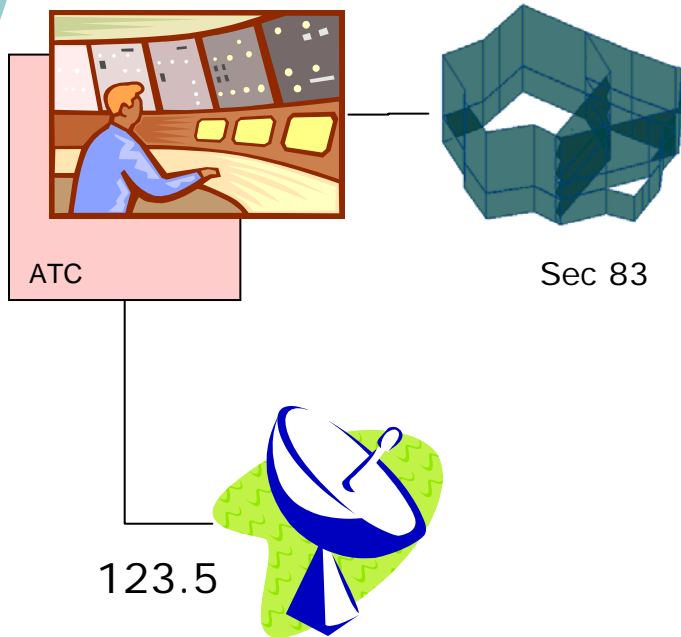

# Organizations and Services

## AICM Example

---

4

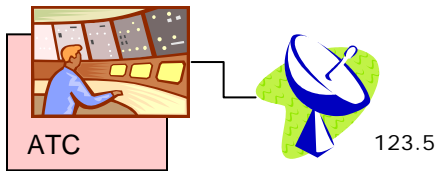

```
<Ser>
  <SerUid>
    <UniUid>
      <txtName>ZHU</txtName>
    </UniUid>
    <codeType>ATC</codeType>
    <noSeq>1</noSeq>
  </SerUid>
  <codeSource>FAA</codeSource>
  <geoLat>22.00N</geoLat>
  <geoLong>142.00W</geoLong>
  <codeRadar>Y</codeRadar>
</Ser>
```

```
<Fqy>
  <FqyUid>
    <SerUid>
      <UniUid>
        <txtName>ZHU</txtName>
      </UniUid>
      <codeType>ATC</codeType>
      <noSeq>1</noSeq>
    </SerUid>
    <valFreqTrans>123.5</valFreqTrans>
  </FqyUid>
  <uomFreq>MHZ</uomFreq>
  <valFreqRec>123.5</valFreqRec>
  <Cdl>
    <txtCallSign>Houston Center</txtCallSign>
    <codeLang>EN</codeLang>
  </Cdl>
</Fqy>
```

# Organizations and Services

## AICM Example

---

5

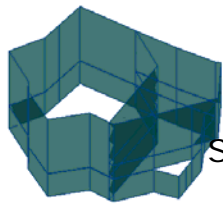

Sec 83

```
<Sae>
  <SaeUid>
    <SerUid>
      <UniUid>
        <txtName>ZHU</txtName>
      </UniUid>
      <codeType>ATC</codeType>
      <noSeq>1</noSeq>
    </SerUid>
    <AseUid>
      <codeType>SECTOR</codeType>
      <codeId>ZHU83</codeId>
    </AseUid>
  </SaeUid>
</Sae>
```